

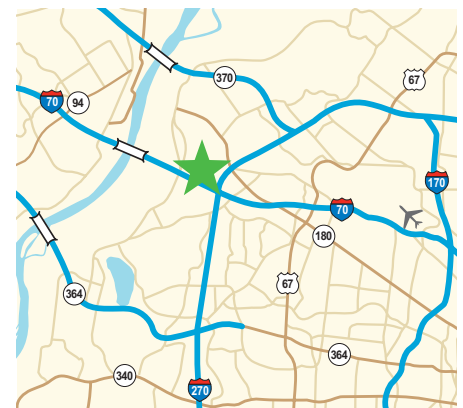

Earth City 7 | 4301 Rider Trail North, Suite 150 | Earth City, MO 63045

Property Highlights

- 70,000 SF available
- 1,853 SF office
- 50' x 50' column spacing
- 28'-30' clear height
- 13 (9'x10') dock doors with shelters
- 1 (12' x 14') ramped concrete drive-in door
- 7 36k lb pit levelers
- 200' building depth
- ESFR sprinkler system
- Desirable Earth City location with easy access to I-70, I-270 and I-370
- 2014 estimated operating expenses: \$1.68
- **Lease rate: \$4.15 NNN**



For more information, contact:

Ed Lampitt, CCIM, SIOR
314.746.0383
Ed.Lampitt@cassidyturley.com

Matt Eastin
314.746.0350
Matt.Eastin@cassidyturley.com

7700 Forsyth Boulevard
9th Floor
St. Louis, Missouri 63105

cassidyturley.com

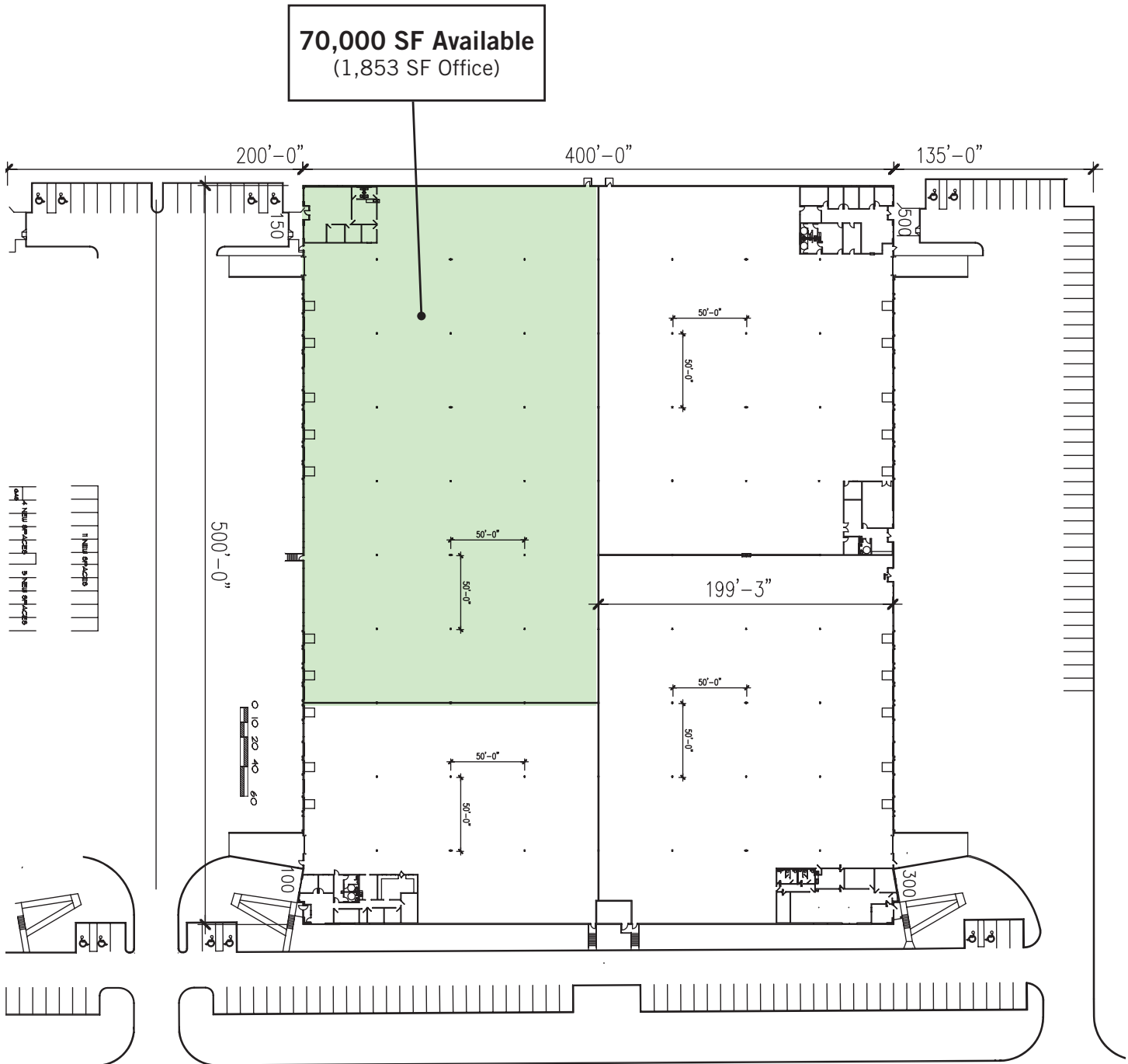

For more information, contact:

Ed Lampitt, CCIM, SIOR

314.746.0383

Ed.Lampitt@cassidyurley.com

Matt Eastin

314.746.0350

Matt.Eastin@cassidyurley.com

7700 Forsyth Boulevard

9th Floor

St. Louis, Missouri 63105

cassidyurley.com